



ANALYTIC SYSTEMS

Power Conversion Solutions

DC/DC CONVERTERS

MODEL VTC90

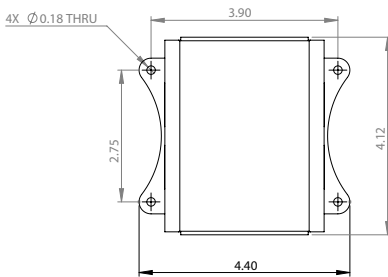

TOP VIEW

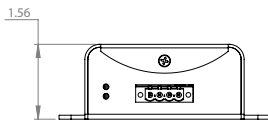

FRONT VIEW

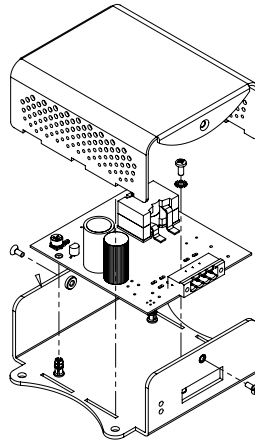

EXPLODED VIEW

Benefits

- Rugged & Reliable
- Power sensitive electronics without interference
- Ultra-Quiet
- Ensure years of safe and trouble free operation

Design Features

- Standard input voltage range allows operation from 20 up to 100VDC power systems
- Standard output voltages: 12, 24, 32, 48, 72 or request any output voltage between 9VDC and 96VDC. For output current refer to output current table on the back of this data sheet.
- Reverse input protection
- High tolerance for shock and vibration
- Short circuit protection
- Output over-voltage crowbar
- Inrush Current Limiting
- Easily mounted
- Remote On-Off version available (call factory for details)
- Wide-Temperature option Available
- Conformal Coating and/or Harsh Environment Ruggedization available
- Ultra-quiet low EMI operation
- 3 year parts and labour warranty

Description

The VTC90 Step Down Series of Voltage Converter supplies standard 12V, 24, 32V, 48V or 72VDC output from 20VDC to 100VDC power systems for use in heavy equipment, marine, industrial, or alternative energy environments. Many customizable input/output options. Power output from 10A down to 1 A is dependent on the I/O choice.

New high frequency design offers higher reliability, higher efficiency (up to 93%), more power (up to 10A at 12VDC out) and minimum size. SMT production

The unit has reverse input protection, output current limiting and output overvoltage protection.

Applications

- Natural gas + Oil Patch
- Mobile Command Vehicles
- Marine / Automotive / RV
- Industrial Controls (OEM Applications)
- Field Work / Construction Sites
- Solar / Alternative Power Systems

An ISO9001 and AS9100 Registered Company Battery Chargers • Inverters • Power Supplies • Voltage Converters

8128 River Way, Delta B.C. V4G 1K5 Canada T. 604.946.9981 F. 604.946.9983 TF. 800.668.3884 (US/CANADA)

www.analysicsystems.com

		Input Volts				Output Crowbar	
		Nominal	24	36	48		72
		Min / Max	20 / 32	30 / 48	40 / 64		60 / 96
Output Volts	Nominal	Actual	Output Amps			Output Crowbar	
	12	13.6	10.0 / 12.0	8.1 / 10.0	7.0 / 8.4	5.7 / 7.0	16
	24	27.2		5.7 / 7.0	5.0 / 6.0	4.1 / 5.0	32
	36	40.8			4.1 / 5.0	3.3 / 4.0	45
	48	54.4				2.9 / 3.5	60
Volts		Continuous / Peak				Volts	

Electrical (Output)	
Output Ripple & Noise	< 10 mV
Transient Response	< 1V for 50% Surge
Regulation (Line & Load)	< +/- 0.5%
Durability	Peak 20% for 10 min maximum Continuous 100% for 24 hours per day
Efficiency	> 93% @ Maximum Output

Environment Specification	
Operating Temp. Range	-25° to +40°C @ maximum output Derate Linearly 2.5% per °C from 40°C (Optional -40°C TO +55°C extra wide temp. operation available)
Humidity	0 – 95% Relative Humidity (non-condensing) with optional conformal coating
Audible Noise	NONE Ødb @ 3 ft
Typical Service Life	> 10 yrs. (87,600 hrs)
Isolation	Any Input or Output to Case 1500 VDC Input to Output – Common Negative

Mechanical Specification	
Length	4.12 in / 10.5 cm
Width	4.30 in / 10.9 cm
Height	1.57 in / 3.96 cm
Material	Marine Grade Aluminum
Finish	Black+Blue Anodize / Powder Epoxy Coat
Fastenings	All 18-8 Stainless Steel
Weight	0.62 lb / 0.28 kg
Connections	Pluggable 4 position contact terminals
Warranty	3 years
Safety	Designed to meet CSA 22.2.107.1 & UL458

Note: Specifications are subject to change without notice.



ANALYTIC SYSTEMS
Power Conversion Solutions

An ISO9001 and AS9100 Registered Company Battery Chargers • Inverters • Power Supplies • Voltage Converters

8128 River Way, Delta B.C. V4G 1K5 Canada T. 604.946.9981 F. 604.946.9983 TF. 800.668.3884 (US/CANADA)

www.analysissystems.com